



Wiper System

A function which utilizes a rain sensor to detect the volume of rain drops hitting the windshield surface and operates the wiper blades at the optimum wiping interval is provided as standard for Europe and Australia and as an option for G.C.C. countries. For example, the wipers are operated automatically, when the wiper switch is in the AUTO position, even when water splashed up by an oncoming vehicle suddenly hits the windshield, obstructing visibility.

The length of the wiper blade on the driver's side has also been extended from the previous 550 mm to 600 mm. This helps to increase the amount of water that is wiped off. This function assures the driver of good visibility when it is raining.

The wiper blades coated with graphite to reduce friction and wiper flapping noise.

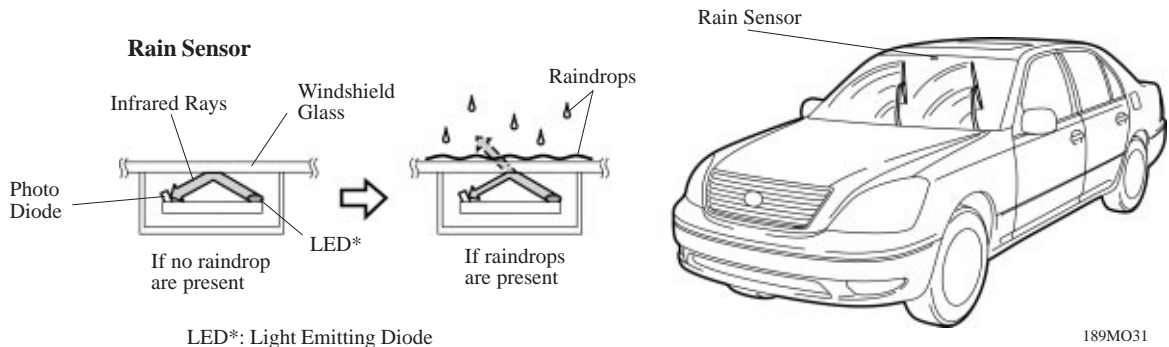

MO



Theft Deterrent System

When any attempt is made to forcibly enter the vehicle, open the engine hood or trunk lid, unlock any door or trunk lid without a key, or when the battery terminal are removed and reconnected, this system sounds the vehicle horn and security horn*¹ and self power siren*², flashes the interior light, hazard lights, taillights*¹ and headlights*¹, to deter illegal or mischievous activities. At the same time it locks all doors, if any of the door is unlocked during alarm.

(*¹: G.C.C. countries and Australia. *²: Europe only)



Engine Immobiliser System

This system is constructed so that the engine will only start when the ID code of the transponder chip embedded in the key matches the code registered in the transponder key ECU or, for models with the smart key system, the code registered in steering lock ECU.



Door Closer System (Option)

Door closer system can be installed for all the doors. If the switches in door closer assemblies detects that a door is ajar, it activates a closer motor which automatically pulls the door so that it closes fully. Not only does this function help to prevent door ajar, but they enable the doors to be closed gently by a small amount of force.

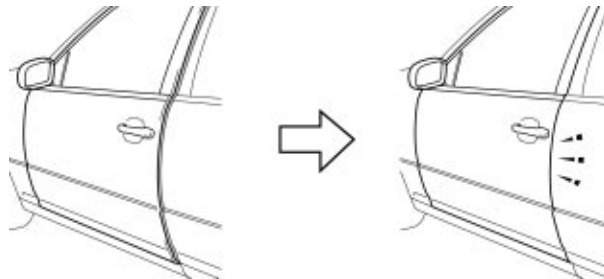

189MO43