

EQUIPMENT

The equipment package offered for the LS430 sets no limits as to the pursuit of luxury. These features were designed to fulfill the satisfaction of all your passengers.



Seat

High quality seats which immerse you in a feeling of elegance.

Semi-aniline Leather (Option)

Due to the improved coating and endurance of leather, the look and feel of the highest quality soft leather is available as an option.

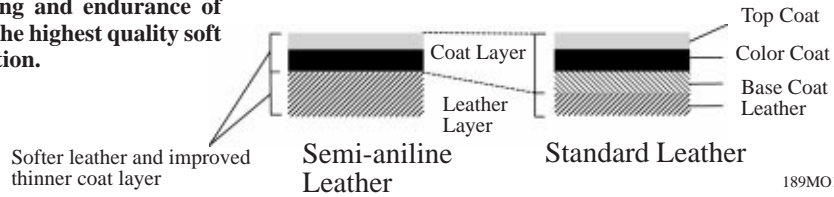

189MO11

Front Seat

Adjustable Seat Cushion Length System (for Driver's Seat)

An adjustable seat cushion system enables to move the driver's seat leading edge (cushion part) forward and backward, as well as up and down. It allows the optimum driver's posture, regardless of body type or physique.

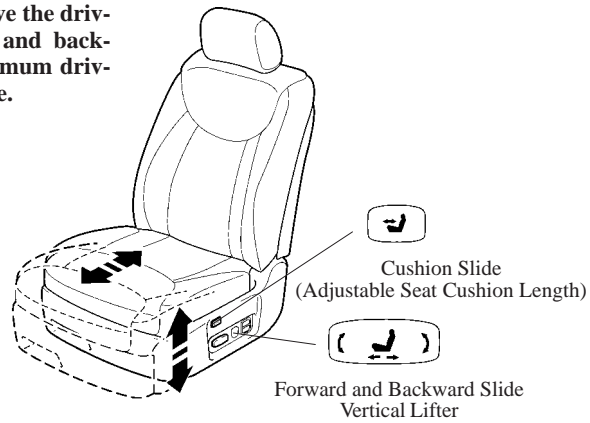

189MO12

Power Dual Lumbar Support (for Driver's Seat)

Using the lumbar support switch mounted in the seat cushion shield of the driver's seat, the upper and lower torsion bars can smoothly and independently be adjusted forward and backward.

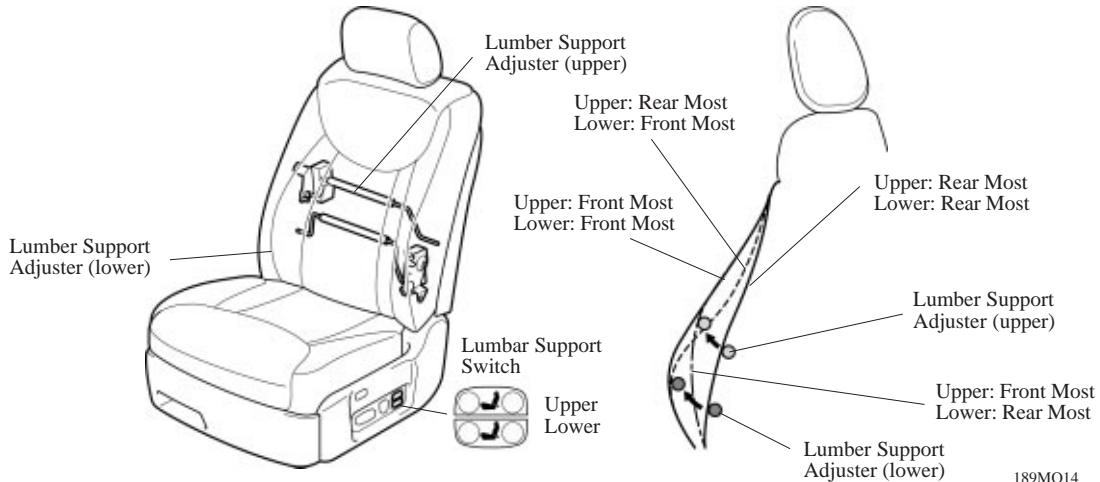

189MO14

Slide Interlock Adjusted Headrest System (for Driver's Seat)

When the seat is moved forward or backward (fore-and-aft slide), this system moves the headrest to the optimum position automatically. It is also possible to adjust the headrest to a desired setting manually. A memory function is provided to save these seat adjustment settings.

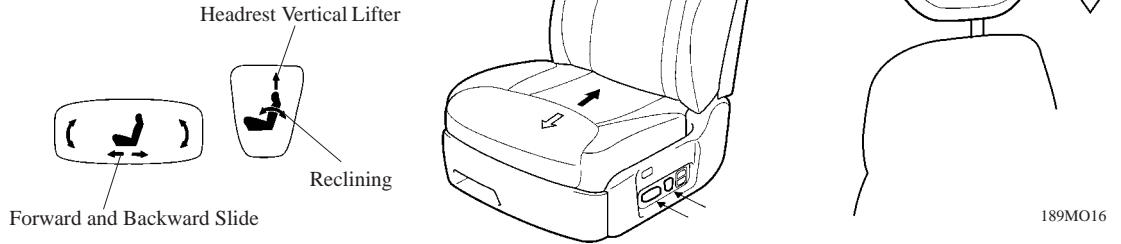

MO

Climate Control Seat (Option)

A climate control seat, which controls the surface temperature of the seat cushion and seatback by blowing warm air, cold air or airflow helps to reduce discomfort when passengers sit down and is available as an option.

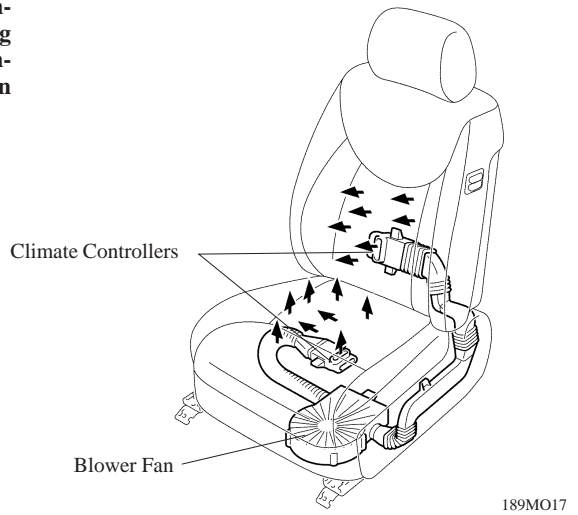

Rear Seat

Rear Power Seat (Option)

Available as an option is a rear power seat, which is equipped with a seat vibrator, a seat slide memory function, and a door open linked return function that returns the rear seat to its set position automatically when the rear door is opened. From entry to exit, comfort and efficiency are assured.

On the center armrest, control switches for each function have been adopted.

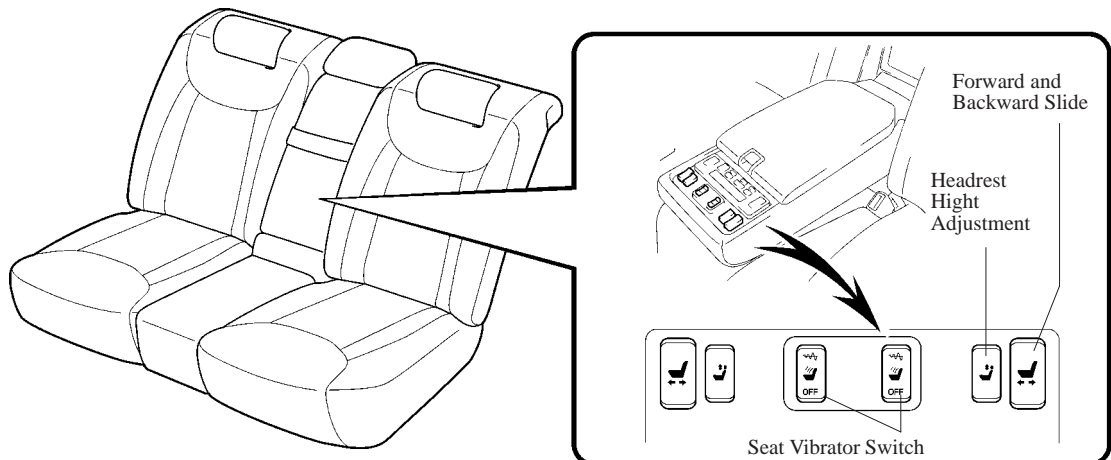

EQUIPMENT

CRS (Child Restraint System) Anchor System

ISO-FIX bar have been provided between the rear seat's seatback and seat cushion.

CRS anchor brackets, with covers, have been installed on the package tray. When not used, the CRS anchor brackets are covered so the package tray has no protrusions. (Australia only)

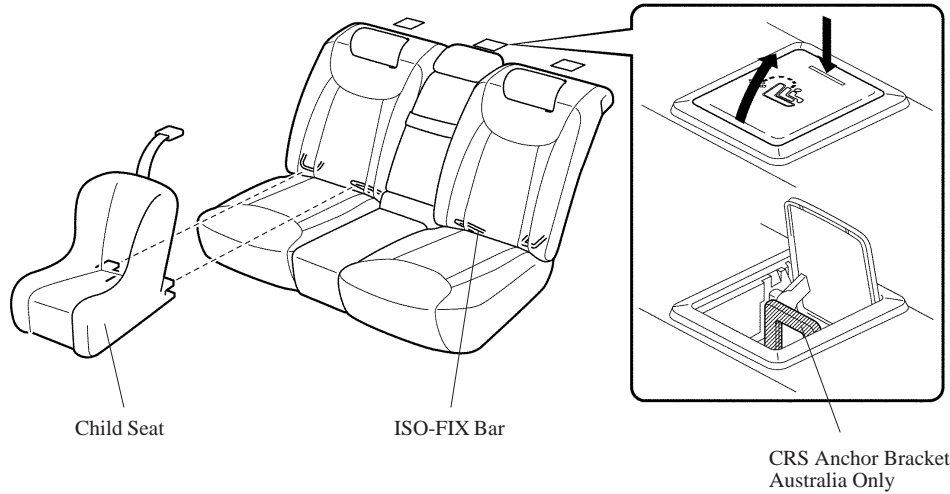

Air Conditioner

In order to assure a comfortable interior space, a number of new technologies have been incorporated in the air conditioning system together with detailed control which matches human senses.

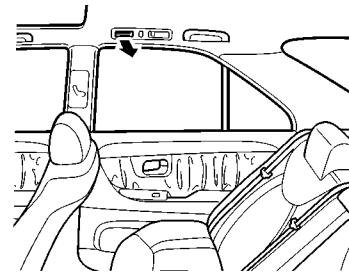
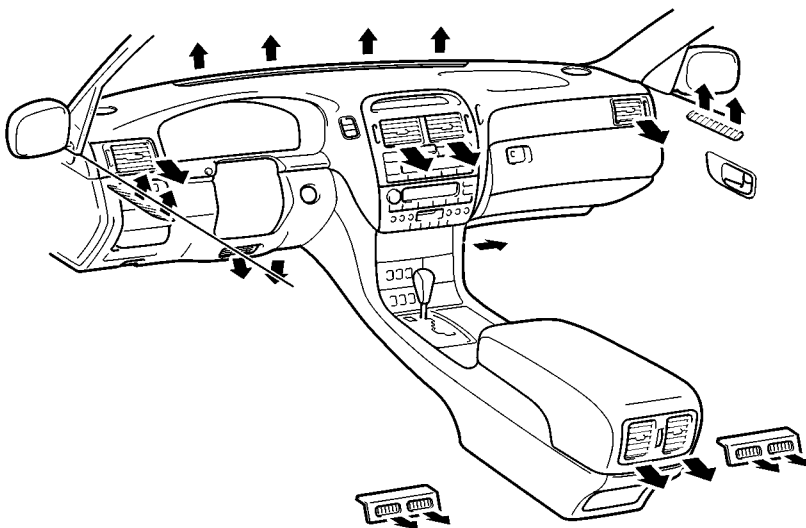

189MO20